

CADEX UNITIZED SCOPE MOUNT INSTRUCTION SHEET

Part#: 1556 / 1556-QD / 1556-QD-CANT



A- INSTALL UNITIZED SCOPE MOUNT ON FIREARM TOP RAIL

- QD levers:** Open "quick-detach" levers from the base of the scope mount.
Hex nuts: Unscrew hex nuts fully from the base of the scope mount.
- Align the recoil lug teeth with the slots in the top rail as illustrated below.
- Install the mount on the top rail.
- At this point, push the scope mount forward and close both QD levers (see section B for adjustment if required) or finger tighten the hex nuts.

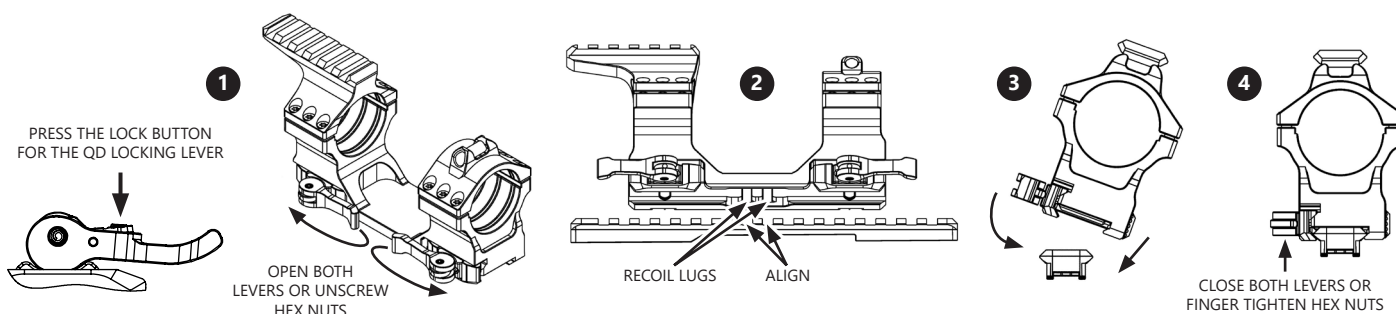
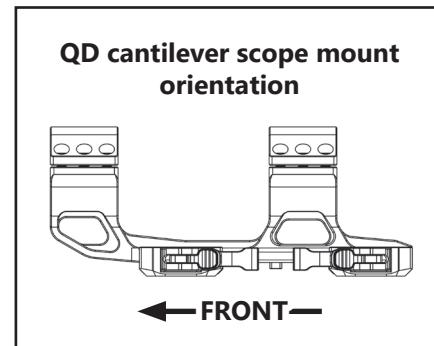

B- QUICK-DETACH LEVERS TENSION ADJUSTMENT

- Open the "quick-detach" levers (image #1).
- Push the pivot of the lever towards the scope mount to release the adjustment nut.
- Turn the adjustment nut "Clockwise" to tighten or "Counter-Clockwise" to loosen.
- Align the scope mount locking pin and push the adjustment nut back in the scope mount.
- Validate proper tension and repeat steps if required.

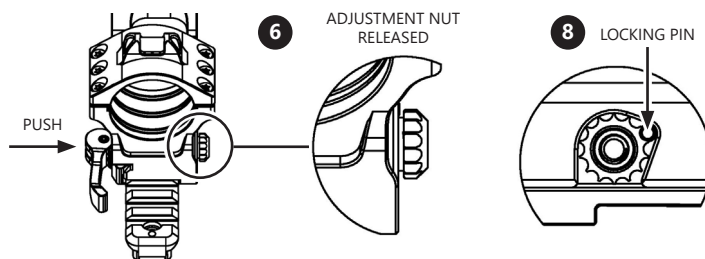

C- INSTALL OPTICAL SIGHT

- Remove both top rings using a T-15 Torx bit and place the optic sight in the scope mount base. Check for eye relief and align reticle.
- Install top rings and ensure alignment.
- Tighten screws in the same order as shown in section D.

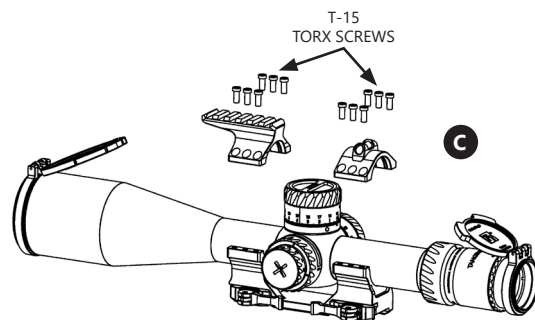

D- UNITIZED SCOPE MOUNT RECOMMENDED TORQUE AND TOOLS

- You will need an adjustable torque wrench with T-15 Torx bit and a level to ensure proper alignment between the scope mount and the optic's reticle.
- Secure all 6 screws to 20-25 in-lb using the order shown beside.

